

Prevention Quick Drills

POCKET TOOLS TRAINING

April 2013

PREVENTION TIPS

Fire Prevention Daily
Quick Drills - Easy Access
to Prevention Topics

Reference:

NFPA Fire Safety in
Manufactured Homes,
NFPA Public Education
Division, 1 Batterymarch Park,
Quincy, MA 02169
www.nfpa.org/education

Tips:

If a room has a window air conditioner, make sure there is still a second way out of the room.

If you sleep with the bedroom door closed, install smoke alarms inside and outside the bedroom. Make sure all smoke alarms are interconnected.

If you have escape ladders for escaping from the second and third floors, make sure they are listed by a recognized testing laboratory and meet ASTM F2175 Standard Specification for Portable and Permanent Emergency Escape Ladders for Residential Use.

If pets are trapped inside your home, tell fire fighters right away. Never reenter a burning building.

Home Fire Escape Plan

Educate the public on the importance of developing a Home Fire Escape Plan.

- 1) Draw a map of the interior of your home showing all doors, windows and stairs.
- 2) Make sure the whole family is familiar with the plan.
- 3) Have the family visit each room and identify at least two ways out.
- 4) Make sure all doors and windows open easily so that they can be used in case of an emergency to get outside.
- 5) Install smoke alarms and test regularly.
- 6) Have a designated family meeting place outside, preferably at the front of the house.
- 7) Make sure your house or building number is visible from the street.
- 8) Learn the emergency phone number for the fire department.
- 9) PRACTICE, PRACTICE AND PRACTICE following the home fire escape plan!

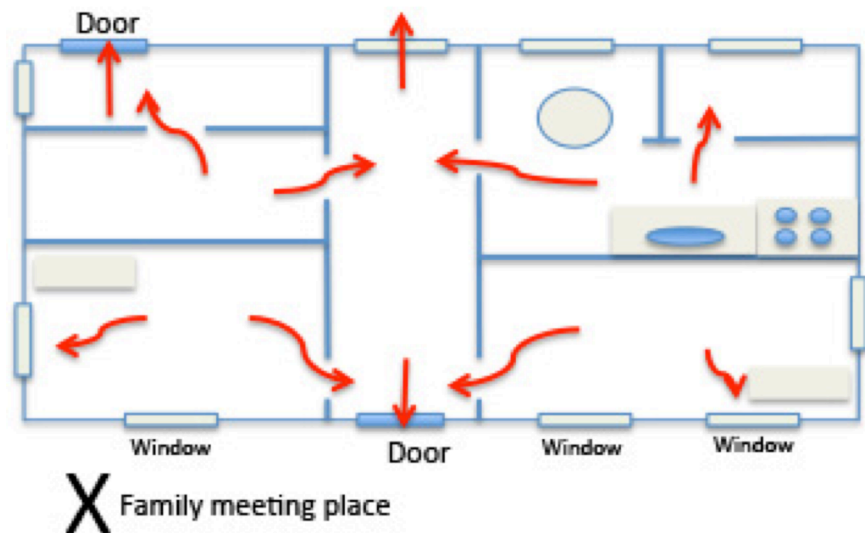

Your Source for SAFETY Information
NFPA Public Education Division • 1 Batterymarch Park, Quincy, MA 02169